



**GRASSROOTS**  
REALTY GROUP

1-833-477-6687  
aloha@grassrootsrealty.ca

1272 30 Street N  
Lethbridge, Alberta

MLS # A2241352

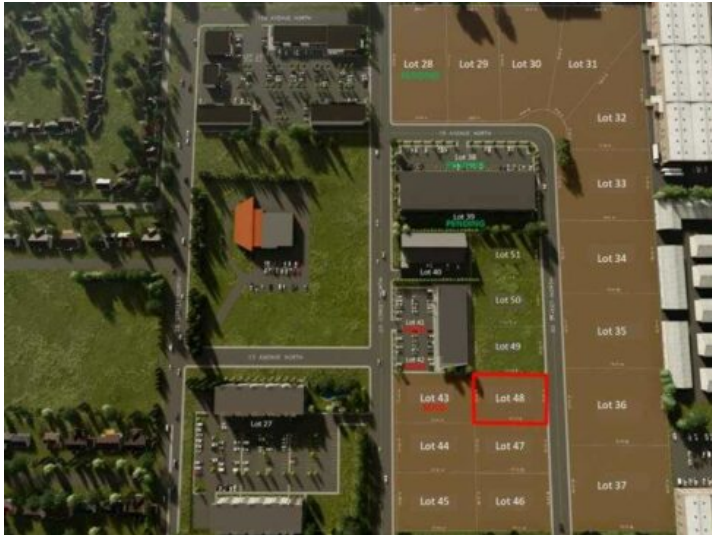

**\$195,000**

Division: NONE

Lot Size: 0.50 Acre

Lot Feat: -

By Town: -

LLD: -

Zoning: DC

Water: -

Sewer: -

Utilities: -

Fibre Optic High Speed Internet Broadcast Business Park offers a unique mixed use project with land sales built to suit opportunities in a highly visible location. Individual lots of various sizes are available, ranging from 0.5 - 1.00 acres which can be combined to form a bigger parcel. The land is in close proximity to mature commercial and residential neighborhoods, including 100+ new residential units in the Broadcast Business Park. Excellent access from 28th Street North