



**GRASSROOTS**  
REALTY GROUP

1-833-477-6687  
aloha@grassrootsrealty.ca

**855 Gershaw Drive SW  
Medicine Hat, Alberta**

**MLS # A2243379**

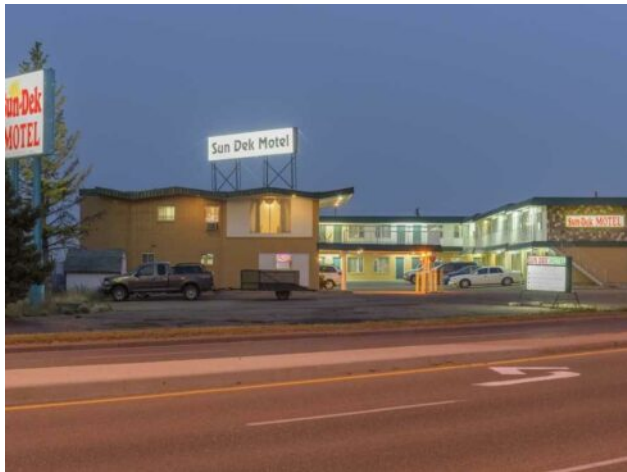

**\$2,190,000**

**Division:** SW Hill

**Type:** Hotel/Motel

**Bus. Type:** Hotel/Motel

**Sale/Lease:** For Sale

**Bldg. Name:** -

**Bus. Name:** -

**Size:** 15,944 sq.ft.

**Zoning:** C-H

**Heating:** -

**Addl. Cost:** -

**Floors:** -

**Based on Year:** -

**Roof:** -

**Utilities:** -

**Exterior:** -

**Parking:** -

**Water:** -

**Lot Size:** 0.86 Acre

**Sewer:** -

**Lot Feat:** -

**Inclusions:** N/A

50 UNIT WITH MANAGER SUITE IN MEDICINE HAT. HIGH VISIBILITY AND EASY ACCESS FROM HIGHWAY. VERY GOOD LOCATION. STEADY INCREASE IN SALES YEAR OVER YEAR. VERY GOOD SIZE FOR FAMILY OPERATION. GOOD INCOME. EASY OPERATION.