



GRASSROOTS
REALTY GROUP

1-833-477-6687
aloha@grassrootsrealty.ca

130 Pelican Place
Sylvan Lake, Alberta

MLS # A2247975

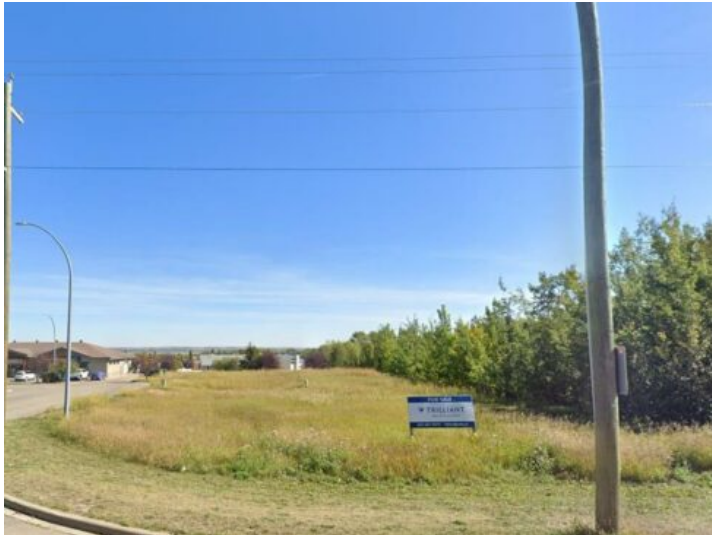

\$995,000

Division: NONE

Lot Size: 0.71 Acre

Lot Feat: City Lot, See Remarks

By Town: -

LLD: -

Zoning: DC-50

Water: Public

Sewer: Public Sewer

Utilities: Electricity at Lot Line, Natural Gas at Lot Line

Prime Commercial Development Opportunity in Sylvan Lake Seize this rare chance to secure 0.71 acres of premium commercial land in the sought-after Pelican Place area. Perfectly positioned with excellent visibility and access, this property offers a blank canvas for your business vision—whether it’s retail, office, hospitality, or mixed-use. Enjoy the benefits of DC-50 zoning, providing flexibility for a variety of development possibilities. Utilities including electricity and natural gas are already at the lot line, saving you time and cost during construction. With 81 meters of frontage and 41.5 meters of depth, you have the space to create an impressive presence in one of Sylvan Lake’s growing commercial hubs. Located in a vibrant community just minutes from the lakefront, this lot is ideal for attracting both local traffic and seasonal visitors. Immediate possession means you can start your project without delay. Bring your vision to life in a location where business thrives—your future starts here at 130 Pelican Place.