



GRASSROOTS
REALTY GROUP

1-833-477-6687
aloha@grassrootsrealty.ca

**W4R26T25S16:5,6 Range Road 264
Rural Wheatland County, Alberta**

MLS # A2273577

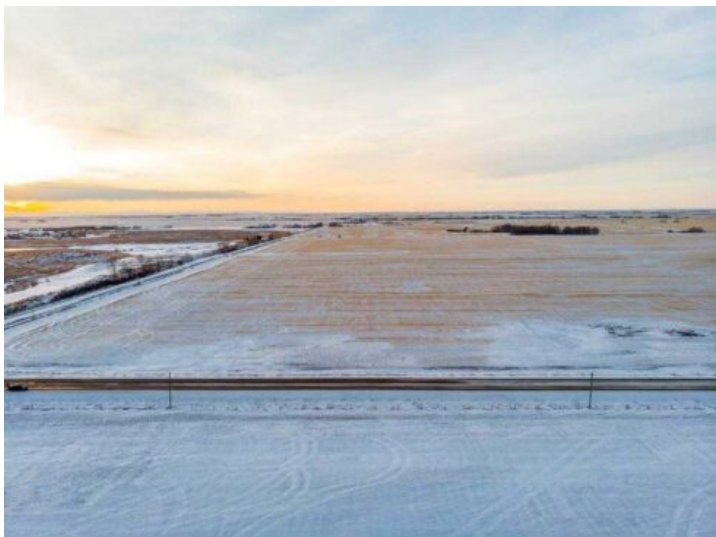

\$3,517,493

Division: NONE

Lot Size: 79.50 Acres

Lot Feat: -

By Town: Strathmore

LLD: 16-25-26-W4

Zoning: HRG

Water: None

Sewer: -

Utilities: -

Prime farmland located within the Area Structure Plan WC ASP - 11-012. (Parcel # 2 on Google Map) This prime piece of Real Estate is situated on pavement and is an easy commute to Calgary (20 minutes), and only 15 minutes to either Strathmore or Chestermere. Aligned with all the major transportation corridors of Highway #1, Highway 564, Highway #9 and Glenmore Trail; this fabulous location avails developers to all the major roadways leading to the city and adjacent communities. Within steps of Lakes of Muirfield 18 hole Golf Course, a convenience store and liquor store. There is a service station and food outlets nearby. Opportunity knocks to become the leader in developing this Area Structure Plan further. There is a high pressure gas line installed that will service 180 home sites. Along with this 80 acre parcel are adjoining parcels totaling another 500 acres for sale within the ASP. An opportunity to purchase for the future and develop as you go. Near De Havilland site.