



**GRASSROOTS**  
REALTY GROUP

1-833-477-6687  
aloha@grassrootsrealty.ca

**15 Bear Creek Drive  
High Level, Alberta**

**MLS # A1043540**

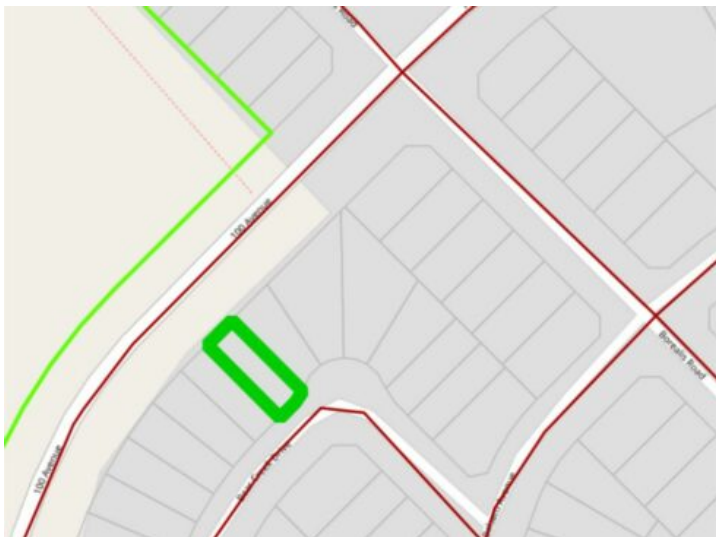

**\$42,750**

**Division:** NONE

**Lot Size:** 0.11 Acre

**Lot Feat:** -

**By Town:** -

**LLD:** -

**Zoning:** Residential

**Water:** Public

**Sewer:** Public Sewer

**Utilities:** Electricity at Lot Line, Natural Gas at Lot Line

There are so many reasons why this may be the perfect location for your new home. LOCATION, LOCATION, LOCATION!!! Close to the hospital, shopping, the Toy Lending Library and then there's the price? This neighborhood is zoned R-2 which means manufactured and modular homes, an economical alternative to stick built homes, are permitted uses. DEVELOPERS?? An awesome location to build revenue properties.