



**GRASSROOTS**  
REALTY GROUP

**1-833-477-6687**  
aloha@grassrootsrealty.ca

**109 6A Street**  
**Beaverlodge, Alberta**

**MLS # A1129509**

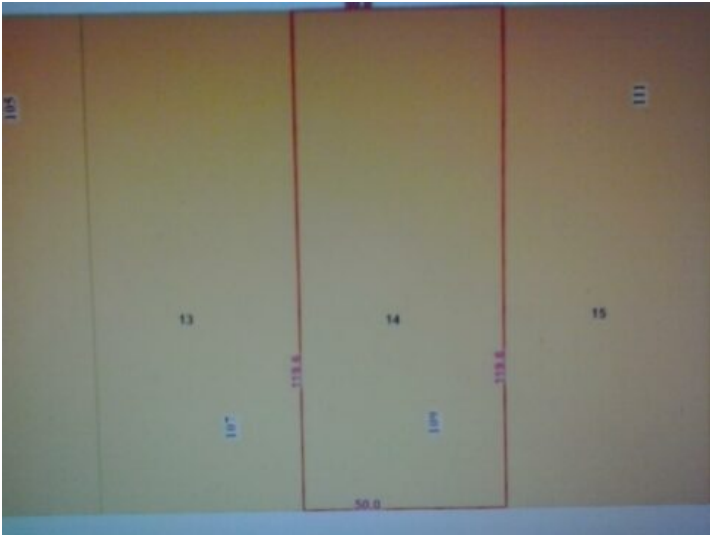

**\$59,900**

**Division:** NONE

**Lot Size:** 0.14 Acre

**Lot Feat:** -

**By Town:** -

**LLD:** -

**Zoning:** R2

**Water:** -

**Sewer:** -

**Utilities:** Cable, DSL, Electricity, Natural Gas, Garbage Collection, Phone, Sewer,

This Property is "SOLD AS IS WHERE IS" and is of land value only, it is located close to downtown, shopping. restaurants. Zoned R2